



FIRST LIGHT
SAFETY PRODUCTS

FULLY ILLUMINATED STOP ARM

Part #: 100947, 100948, 101259, 101260

INSTALLATION INSTRUCTIONS ► Electric, Front or Rear

Tools Required:

- Drill
- 25/64" drill bit
- Rivet nut installation tool
- ¼ - 20 rivet nut installation tool tip for steel rivets
- 15/32" hex (Allen) bit socket
- Torque wrench (90 in-lbs)
- Wire strippers (16 gauge)
- Crimper for insulated connectors (14-16ga)

1. Remove existing stop arm from the side of the bus.
2. Rivet nuts are required for mounting the new stop arm. Unless rivet nuts have already been installed and are in good condition, the following steps must be followed:
 - A. Drill each of the 4 mounting holes with a 25/64" drill bit.
 - B. Install each of the 4 supplied rivet nuts using the appropriate tool.
3. Clean the mounting surface to ensure a watertight seal.
4. Prepare the wires for connection according to the following diagram. TBB C2 models are equipped with a plug.

- Red** 12V Ignition or constant power
- Blue** 12V Door/Deploy Signal
- Black** 0V/Ground



5. The stop arm comes equipped with mounting hardware. Ensure all hardware shown in image 5 is present.

WARNING: The lighting mode connection will not be accessible after installation. Set the lighting mode to flash or strobe prior to installation (see page 2).

6. You are now ready to mount your new stop arm.

WARNING: When power is first applied the stop arm will partially deploy and then retract. Removing the fuse to disconnect power is recommended.

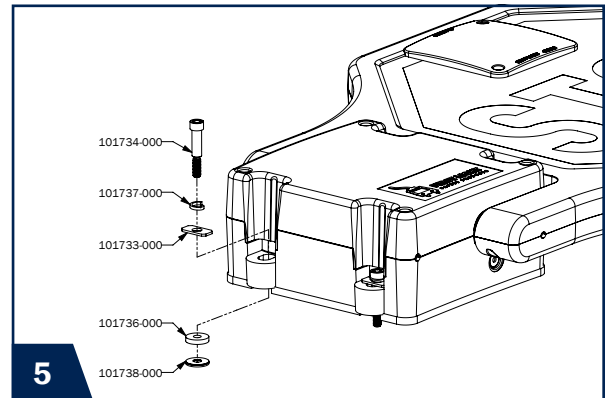
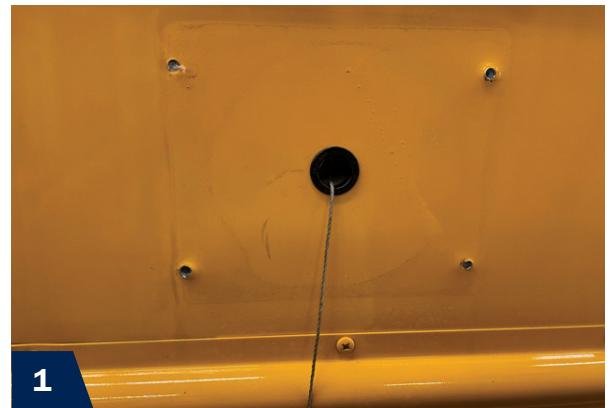

7. Lift and hold the stop arm parallel and away from the bus wall. Connect the wires first. Ensure the connections are locked together and feed the wires into the bus wall.
8. Align the mounting screws with the rivet nuts and tighten evenly in a criss-cross pattern. Tighten to 90 in-lbs.
9. Remove the protective film from the lamps.
10. Activate the stop arms from the bus controls.
11. Perform a final inspection of the stop arm.



SETTING FLASH OR STROBE LIGHTING MODE

- A) Strobe mode: Leave the brown wires connected.
- B) Flash mode: Disconnect the brown wires.

